

# Gyptone® BIG™

ACTIV  
air

## Design and technique

### Product description

Gyptone® BIG™ is a gypsum based acoustic ceiling with high design value since no joints are visible. The ceiling can be used for many applications like schools, offices and commercial settings. Gyptone® BIG™ is screw mounted and non-demountable. The product is subject to full recycling as raw material for new plaster boards.

Gyptone® BIG™ is available with perforated and non-perforated surface. Thickness is 12.5 mm and the format is 1200 x 2400 mm and 900 x 2700 mm.

### Surfaces

The plasterboard surface is subject to paint treatment after installation. Treatment is to be executed with a roller as spray painting will impair the acoustic performance. Joints are to be filled, sanded and painted, c.f. page 3.

### Plenum height

Minimum and maximum plenum heights with GK system in one level is to be found on page 7.

### Fire resistance

A2-s1, d0.

### Loading

Maximum point load is 3 kg. If higher loading is needed the installations are to be fixed to the slab above with dedicated suspensions.

### Stability

Gyptone® BIG™ system is to be installed and used in rooms with relative humidity not exceeding permanently 70% or temperatures exceeding 45 degrees celcius. Gyptone® BIG™ can be curved (dry) to minimum 6 meters radius if installed on preshaped framing.

### Weight

Gyptone® BIG™ Base = 9 kg/m<sup>2</sup>

Other Gyptone® BIG™ products = 8 kg/m<sup>2</sup>

### Cleaning

Can be cleaned with a damp cloth depending on the final surface treatment. Do not use detergents.

### Maintenance

Damages on edges or surfaces can be repaired by filling and painting.

### Accessories

For inspection above install Gyptone® Access Panels into Gyptone® BIG™ Boards. Find more information in installation manual for Gyptone® Access Panel.

### Installation of metal framing (GK/CD system) and Gyptone® BIG™ ceiling boards. Prior to installation it is recommended to read the manual thoroughly.

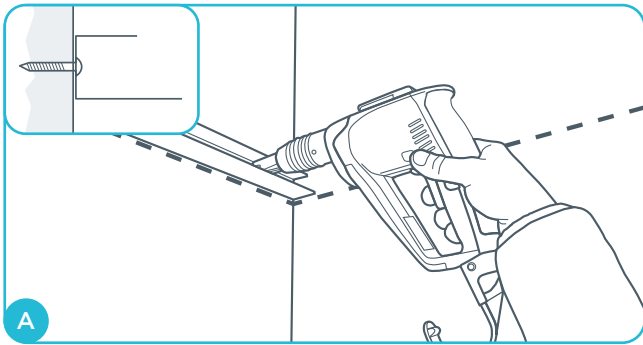

Fix the GK-C edge profile to adjacent surface with appropriate fixing not exceeding cc distance of 400 mm. Carefully use the general specification material of the project as well as this manual.

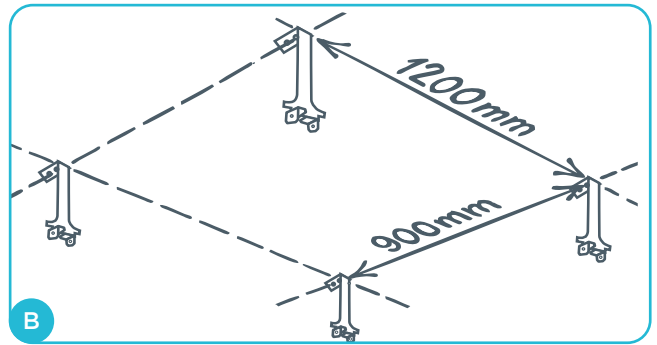

Conduct a survey of the room. Carefully plan for positioning of metal framing, ceiling boards and a potential perimeter. Mark and fix suspension straps with appropriate fixings. Use 2 pcs of clips in connecting GK 27 and GK 26-27.

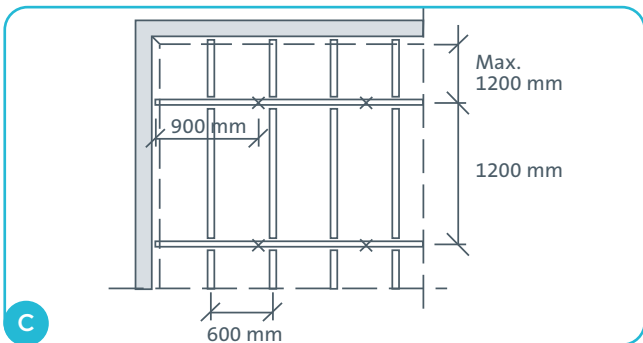

First suspension strap is to be positioned maximum 900 mm from the wall. Main profiles GK 1 positioned maximum 1200 mm from wall. Cross profiles placed with a maximum cc distance of 600 mm between GK 1 main profiles and maximum 600 mm from the wall.

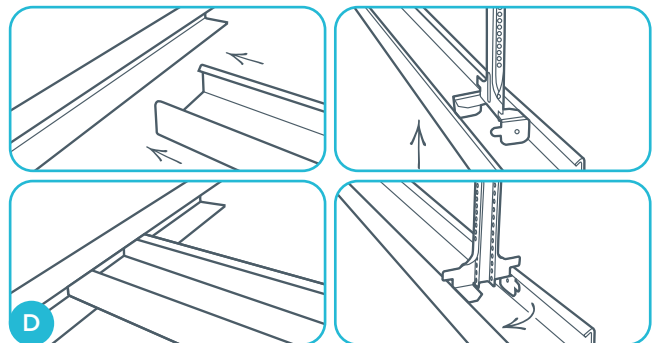

Slide the GK main profile into the GK-C edge profile. Raise the main profile and twist the straps into place. Adjust all main profiles into level.

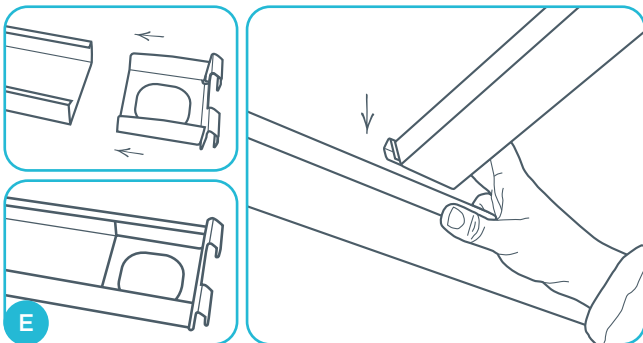

Slide the connector GK 21 into the GK 2 cross profile and click into position between main profiles. 2 clicks must be heard at each connection, when clicking the Cross Profile onto the main profile. Otherwise the Cross Profile will not make a strong connection with the main profile.

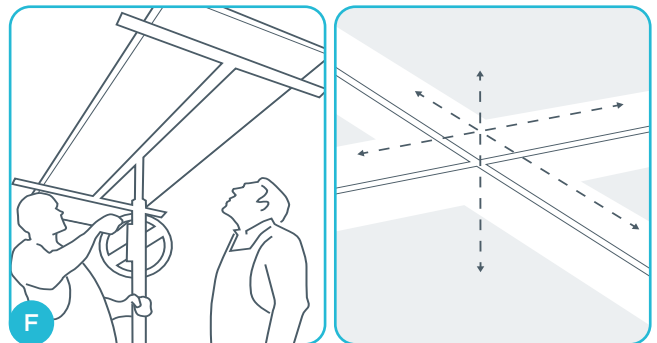

Install the Gyptone® BIG™ Boards by using appropriate lifting equipment and fixing to metal framing with QSTR25 screw. Please note that all joints of boards must be supported by the metal framing. Ensure alignment of the perforation of the boards and keep the boards firmly pressed to the overhead metal framing when screw fixing.

**Installation of metal framing (GK/CD system) and Gyptone BIG™ ceiling boards.**  
Prior to installation it is recommended to read the manual thoroughly.

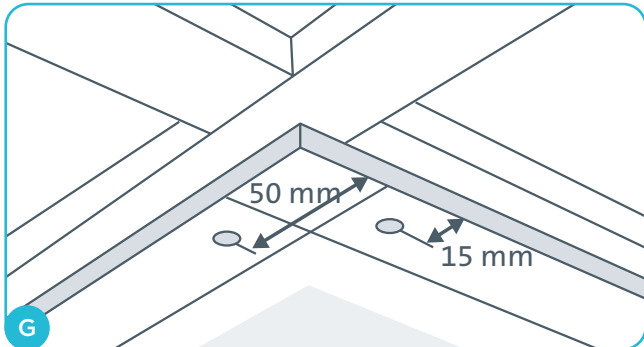

Use a QSTR 25 screw when mounting Gyptone® BIG™ Boards. Distance from screw to corner is 50 mm and from screw to edge 15 mm. Distance cc between screws 200 mm. C.f. page 6 for additional positioning of fixings.

### Finishing

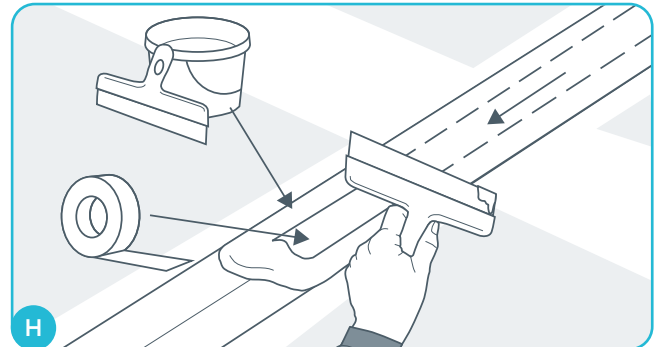

All board joints are to be jointed with adequate filler. Apply first a layer of Gyproc ProMix Joint or the like in the tapered section. Subsequently adding a paper reinforcement in the wet filler. Light sanding (grain 100-200) when cured. Apply a layer of filler Gyproc ProMix Finish or the like. Light sanding when cured until level with board.

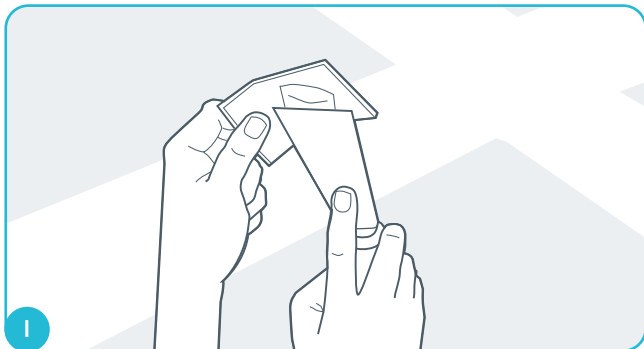

Filling of screw heads with Gyproc ProMix Finish or the like in two rounds finished by a light sanding until level. Tip: Use a piece of plastic with a circular hole as a mould.

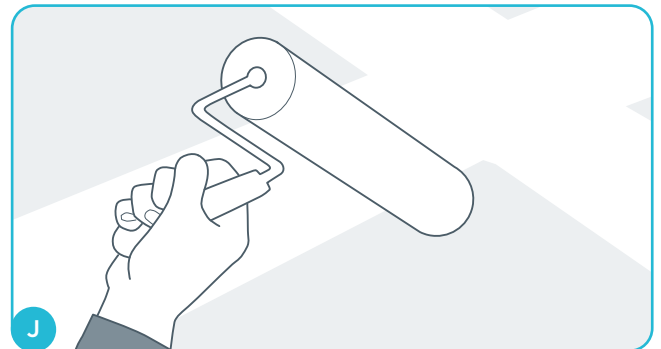

Painting of Gyptone® BIG™ is to be done with a short haired mohair roller to avoid excessive paint into perforation. Spray painting is not to be used as paint will impair the acoustic tissue thus degrading the acoustic properties. Gyptone® BIG™ is to be primed and painted twice.

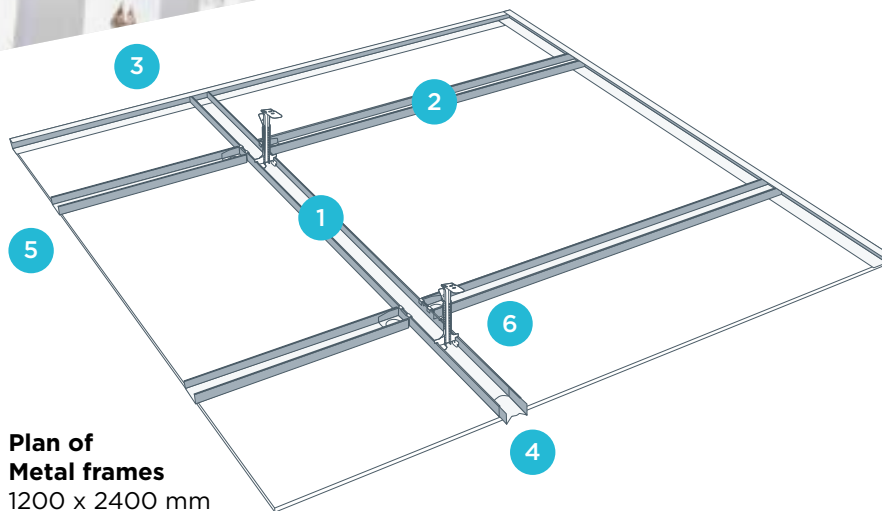

**Plan of  
Metal frames**  
1200 x 2400 mm

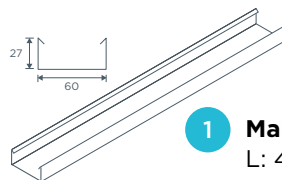

**1 Main profile GK 1**  
L: 4000 mm

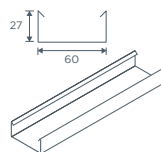

**2 Cross profile GK 2**  
L: 1135 mm

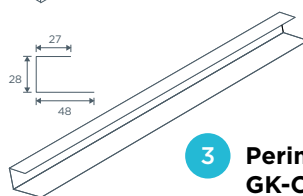

**3 Perimeter channel  
GK-C**  
L: 3000 mm

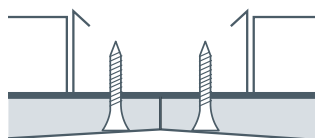

**Tapered edge**



**4 Connector GK 20**



**5 Connector GK**

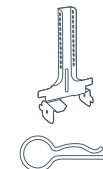

**6a Suspension Strap  
GK 26-27 - base**  
including 2 pcs.  
clips

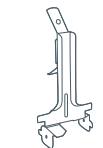

**6b Suspension Strap  
GK 26-25**

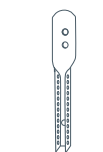

**7 Suspension Strap  
GK 27 - top**  
Lenght: 135/200/  
300/500/1000 mm



**Screw type  
QSTR 25**  
Installation of  
Gyptone edge B1 on  
metal framing

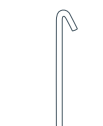

**8 Suspension Wire  
GK 25**

## Estimated consumption suspended installation of GK(CD) system

	Article	Designation	Dimension mm	Lenght mm	CC mm	Consumption/m <sup>2</sup>
1	Main profile	GK 1	27 x 60	4000	1200	0.9 m
2	Cross profile	GK 2	27 x 60	1135	600*	1.7 m
3	Perimeter channel	GK-C	28 x 47	3000	-	By measurement
4	Connector	GK 20	-	-	4000	0.2 pcs.
5	Connector	GK 21	-	-	600	2.8 pcs.
6a	Suspension Strap	GK 26-27	-	-	900	1.0 pcs.
6b	Suspension Strap	GK 26-25	-	-	900	1.0 pcs.
7	Suspension Strap	DK 27-150 ect.	-	-	900	1.0 pcs.
8	Suspension Wire	GK 25-250 ect.	-	-	900	1.0 pcs.

When installing in environment with high humidigy (i.e. RH = 70%)  
cc distancing of maximum 400 mm is recommended.

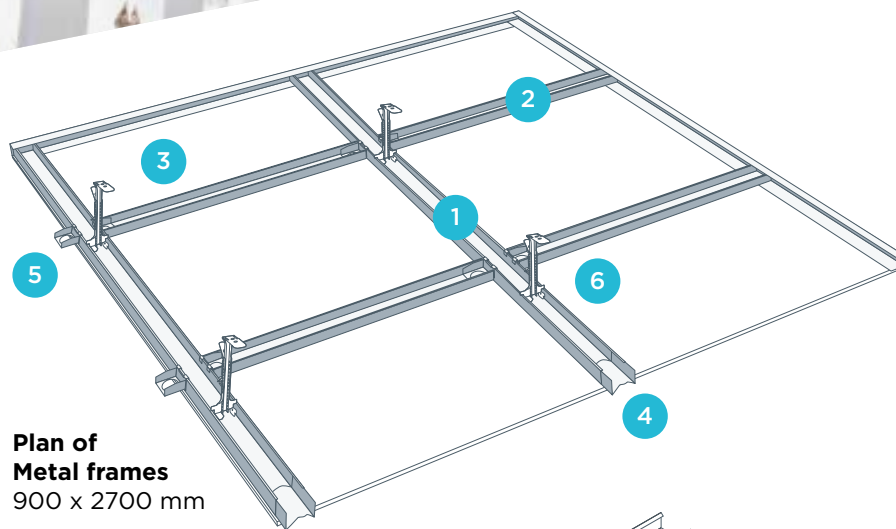

**Plan of  
Metal frames**  
900 x 2700 mm

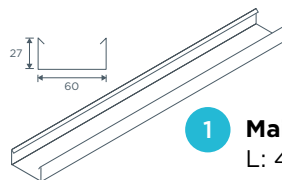

**1 Main profile GK 1**  
L: 4000 mm

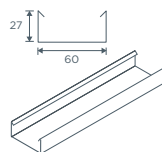

**2 Cross profile GK 2**  
L: 835 mm

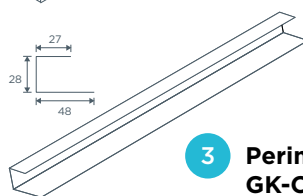

**3 Perimeter channel  
GK-C**  
L: 3000 mm



**4 Connector GK 20**



**5 Connector GK 21**

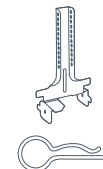

**6a Suspension Strap  
GK 26-27 - base**  
including 2 pcs.  
clips

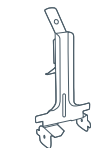

**6b Suspension Strap  
GK 26-25**

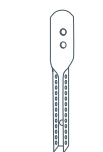

**7 Suspension Strap  
GK 27 - top**  
Lenght: 135/200/  
300/500/1000 mm



**Screw type  
QSTR 25**  
Installation of  
Gyptone edge B1 on  
metal framing

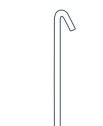

**8 Suspension Wire  
GK 25**

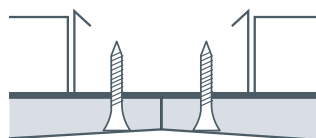

**Tapered edge**

## Estimated consumption suspended installation of GK(CD) system

	Article	Designation	Dimension mm	Lenght mm	CC mm	Consumption/m <sup>2</sup>
1	Main profile	GK 1	27 x 60	4000	900	1.1 m
2	Cross profile	GK 2	27 x 60	835	450*	2.2 m
3	Perimeter channel	GK-C	28 x 47	3000	-	By measurement
4	Connector	GK 20	-	-	4000	0.2 pcs.
5	Connector	GK 21	-	-	600	2.8 pcs.
6a	Suspension Strap	GK 26-27	-	-	900	1.0 pcs.
6b	Suspension Strap	GK 26-25	-	-	900	1.0 pcs.
7	Suspension Strap	DK 27-150 ect.	-	-	900	1.0 pcs.
8	Suspension Wire	GK 25-250 ect.	-	-	900	1.0 pcs.

When installing in environment with high humidigy (i.e. RH = 70%)  
cc distancing of maximum 300 mm is recommended.

### Positioning of screws for edge B1 for 1200x2400 mm and 900x2700 mm Gyptone BIG™. Use screw type QSTR25

GK/CD system. Main profiles per cc distance 1200 mm and cross profiles per cc distance 600 mm

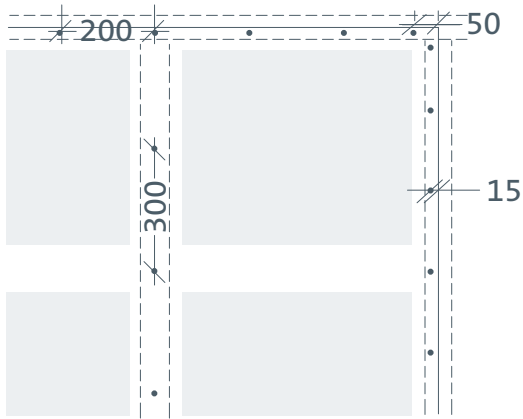

GK/CD system. Main profiles per cc distance 900 mm and cross profiles per cc distance 450 mm

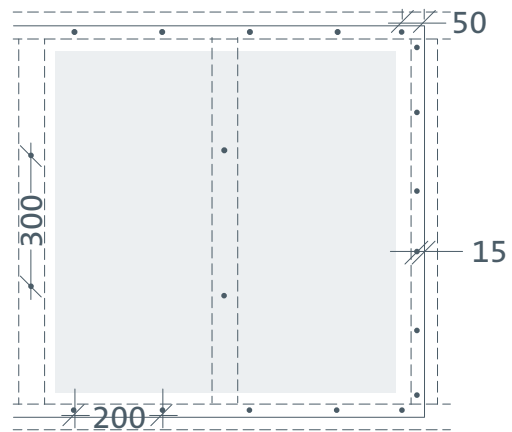

GK/CD system. Main profiles per cc distance 1200 mm and cross profiles per cc distance 600 mm

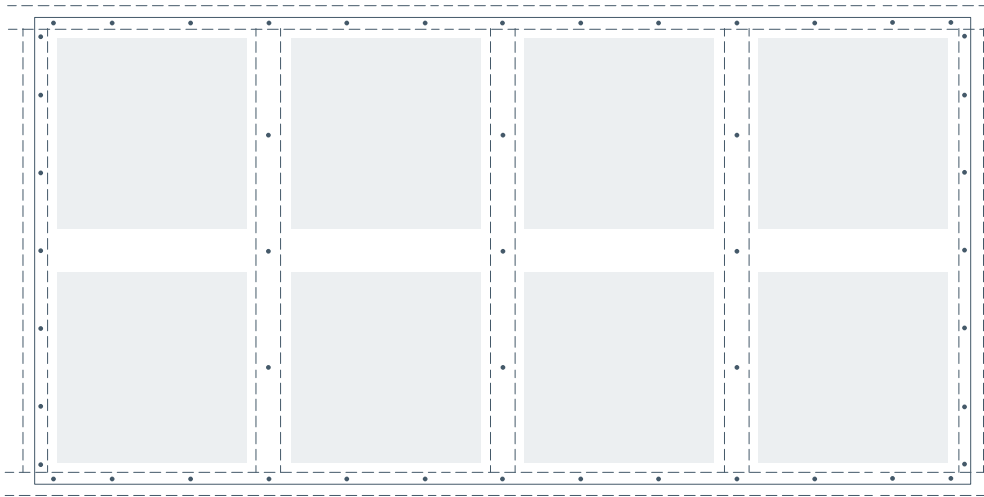

GK/CD system. Main profiles per cc distance 900 mm and cross profiles per cc distance 450 mm

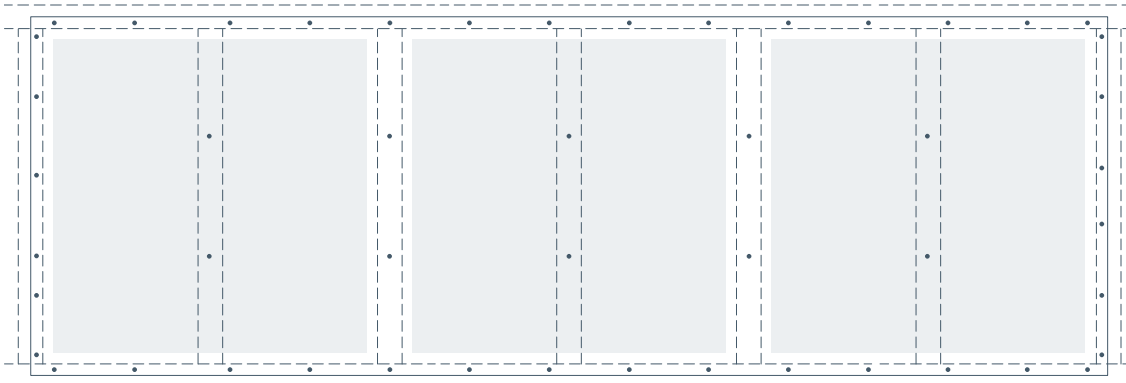

### GK-system in 1 level

Items					
GK26-27 +	GK27 150 mm	Min. height	140 mm	Max. height	180 mm
GK26-27 +	GK27 190 mm	Min. height	140 mm	Max. height	220 mm
GK26-27 +	GK27 290 mm	Min. height	240 mm	Max. height	320 mm
GK26-27 +	GK27 490 mm	Min. height	440 mm	Max. height	520 mm
GK26-27 +	GK27 990 mm	Min. height	940 mm	Max. height	1020 mm
GK26-27 +	GK27 1035 mm	Min. height	985 mm	Max. height	1065 mm
GK26-27 +	GK27 1135 mm	Min. height	1085 mm	Max. height	1165 mm
GK26-25 +	GK25 125 mm	Min. height	125 mm	Max. height	200 mm
GK26-25 +	GK25 250 mm	Min. height	250 mm	Max. height	325 mm
GK26-25 +	GK25 375 mm	Min. height	375 mm	Max. height	450 mm
GK26-25 +	GK25 500 mm	Min. height	500 mm	Max. height	575 mm
GK26-25 +	GK25 750 mm	Min. height	750 mm	Max. height	825 mm
GK26-25 +	GK25 1000 mm	Min. height	1000 mm	Max. height	1075 mm
GK23		Min. height	55 mm	Max. height	110 mm
GK24		Min. height	30 mm	Max. height	30 mm
GK28 100 mm		Min. height	100 mm	Max. height	100 mm
GK28 200 mm		Min. height	200 mm	Max. height	200 mm

Heights are measured from under slab to overside of plaster board.  
Fixing to slab/plenum is not considered.

**GK 26-27 suspension with strap GK 27**

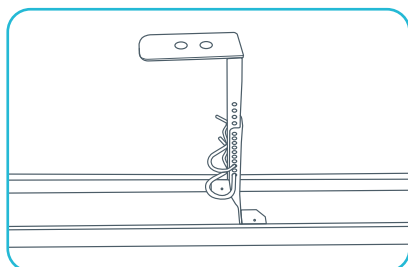

**GK 26-25 suspension with wire GK 25**

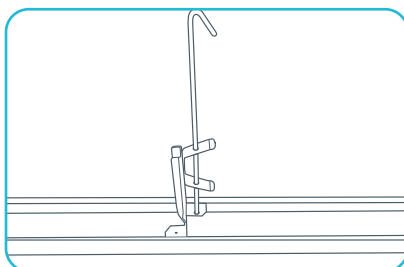

**GK 23 suspension**

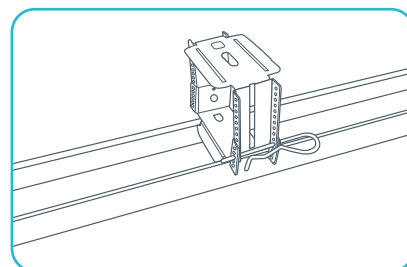

**GK 24 direct fixing**

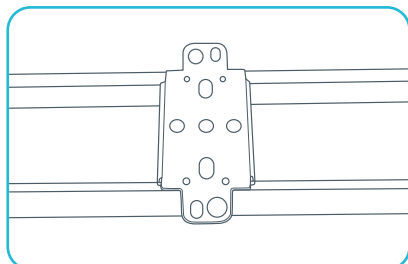

**GK 28 suspension**

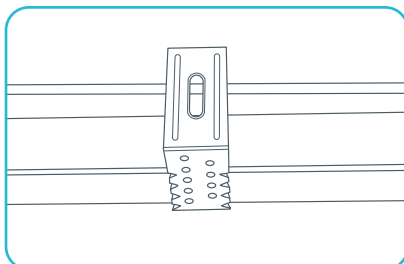



### HELPFUL TIPS

#### Board support

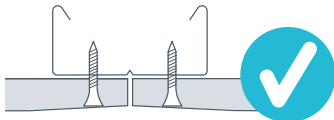

#### 100 % level support

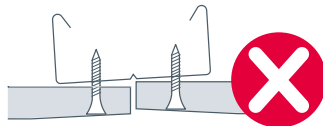
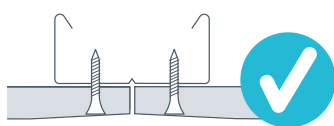

#### Full contact prior to screw fixing

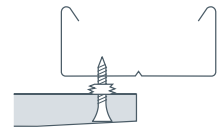
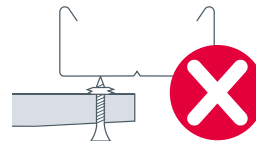
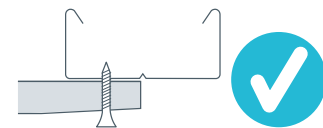
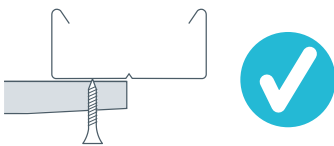

#### Positioning of screws

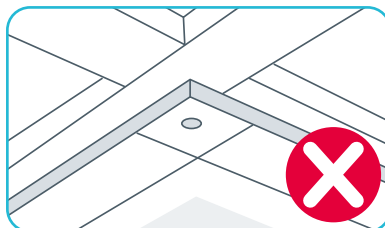
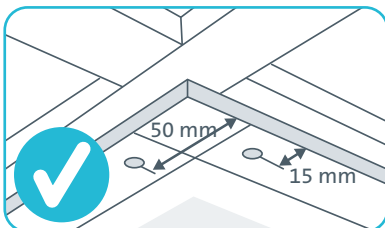

#### Gyptone® BIG™ Boards are to be lifted vertically of the stack

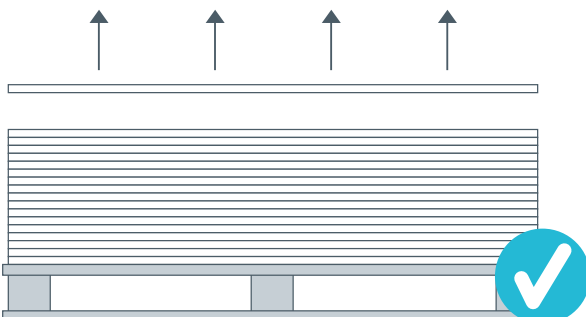

**NB:** By sliding the board risk of rolling of tissue occur which will result in levelling problems by installation.

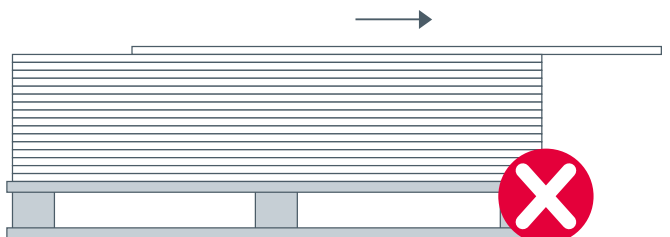



### Check list for installing metal grid and Gyptone® BIG™ Ceiling Boards.

**Prior to installation it is recommended to read the manual thoroughly.**

- ☐ Humidity in room not to exceed 70% during installation or usage.
- ☐ Only usage of Gyproc GK System or similar as metal framing.
- ☐ Fix edge profile GK-C with maximum screw distance of 400 mm.
- ☐ Survey the room and position the straps according to this manual and the general specification of the project.
- ☐ Slide GK 1 main profiles into GK-C edge profile and twist the straps into position.
- ☐ Adjust all GK 1 main profiles into level
- ☐ Fill all joints and screw heads with adequate filler system in accordance with this manual. Subsequently sand until level.
- ☐ Finished surfaces to be primed and painted twice.
- ☐ Have expansion joints in accordance with the project specification been installed?
- ☐ Check positioning of screws on page 6.



#### Saint-Gobain Denmark A/S

Gyproc, Hareskovvej 12  
4400 Kalundborg, Denmark  
Tel. : +45 5957 0330  
Fax: +45 5957 0331  
e-mail: info@gyproc.dk  
[www.gyptone.com](http://www.gyptone.com)



#### ISO and OHSAS

Gyproc A/S has a quality management system, which is certified by BVQI Denmark A/A according to the demands in ISO 9001, 14001 and OHSAS 18001