

## Product description

Gyptone edge D2 is a pre-painted, acoustic suspended ceiling mounted in a concealed 24 mm grid system. Gyptone edge D2 is a fully demountable ceiling and it is subject to inspection in the plenum behind the ceiling. Therefore read this guide, to take care that the tiles are not damaged during removal from the ceiling and reinstallation.

## The edges on a D2 tile

A Gyptone edge D2 tile, consists of 3 different edges. Edge E, D2 and two B edges.

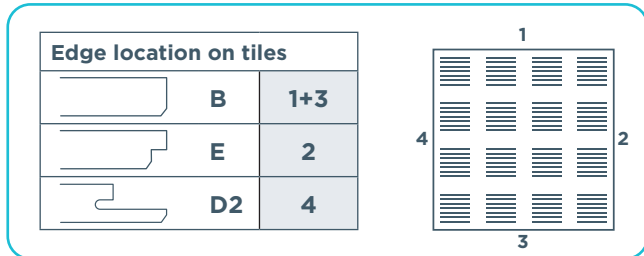

A Gyptone D2 tile is only supported by the grid on 2 sides. This is the E-edge and the D2 edge. If one of these edges is being damaged the tile will no longer be fully attached to the grid.

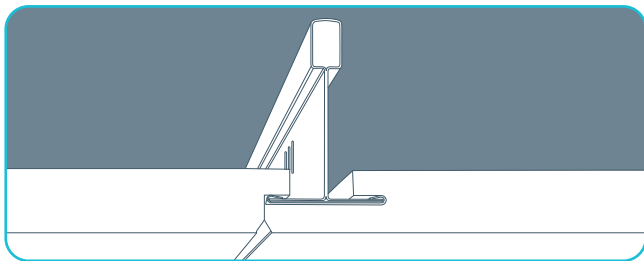

## Handling the D2 tiles

Handling of the D2 tiles shall always be in correspondence with the guidelines in the installation manual. Always use clean gloves both for mounting and demounting the tiles.

## Demounting the D2 tile

When demounting the D2 tiles, it is very important first to locate the E and D2 edge. This is done by gently pushing on the edges until you feel that the tile is lifting.

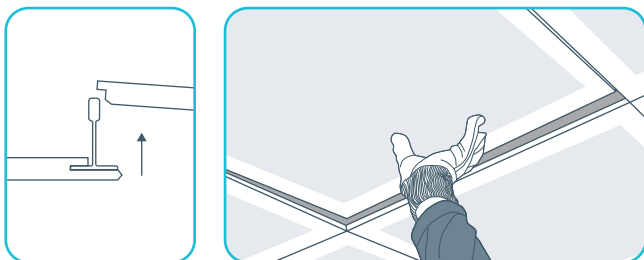

Do not use a lot of force as this can damage the tile. The edge that lifts is the E-edge. To demount the tile, lift the E-edge and slide the D2 edge out of the opposite cross profile. The tile can now be removed from the ceiling.

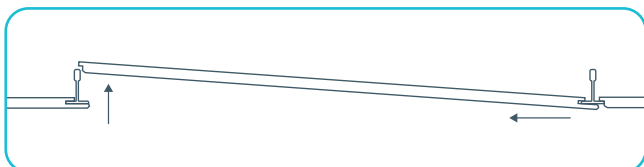

## Handling guide

# Gyptone<sup>®</sup> EDGE D2<sup>™</sup> CROSS-LOCK



Resistance can be met when lifting the E-edge, this can be because of a main profile or ventilation pipe. The tile can still be demounted but it is difficult and if possible try the tile next to it. When the tile is removed from the ceiling, store it in a proper way, so it is not damaged.

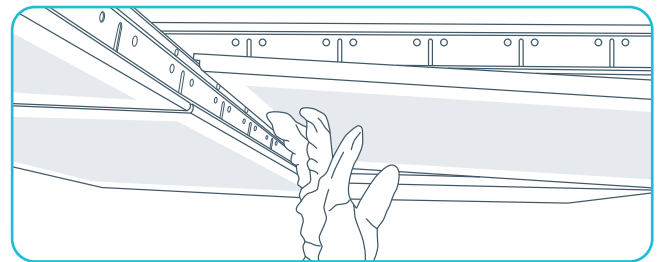

## Installing the D2 tiles after inspection

When installing the tile again, the same method is used as when the tile was originally installed. If more tiles have been removed, it is important that the last tile to be installed have free space above it, if possible. It makes the installation much easier if there are no grid profiles, hangers or installations in the way.

Because the D2 ceiling has a tight fit and the use of wall springs, there can be friction between the tiles, when put back into place. Do not use any tool or similar to force the tile back into place, as this can damage the tile. Align the tiles correctly.

