

Edges and fixing systems
Gyptone ceilings
3.2.1 Edge A

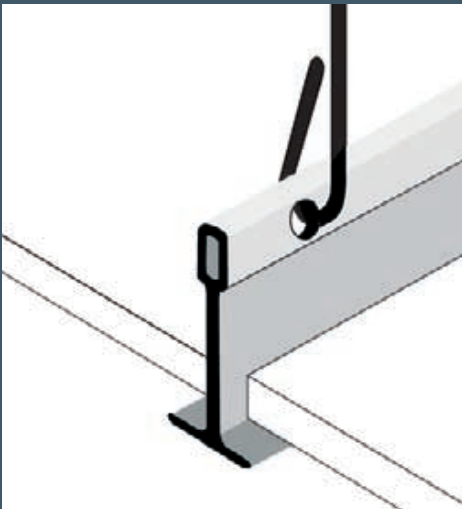

Gyptone®

Reflecting everyday life

Edge A

Exposed grid, suspended – demountable

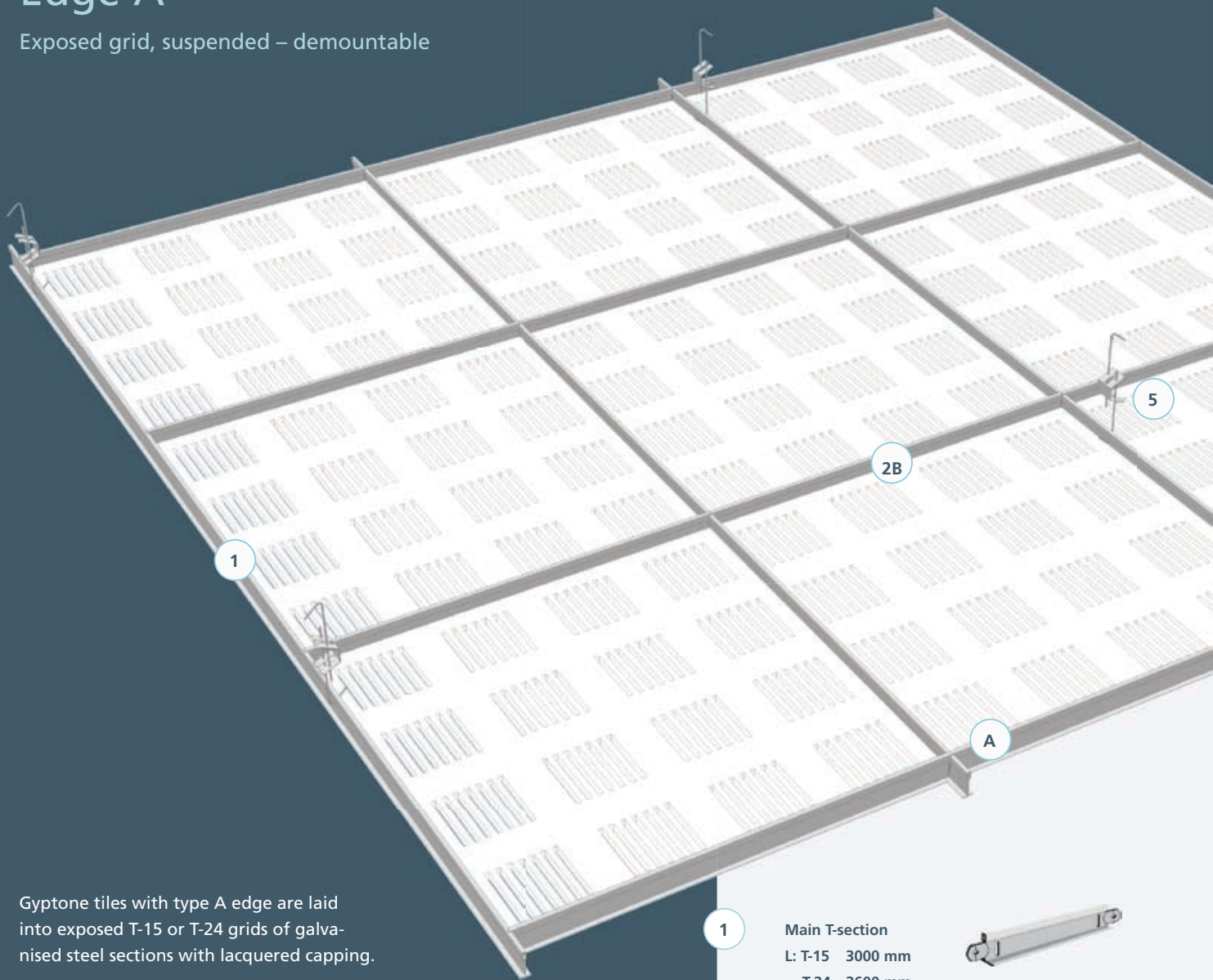

Gyptone tiles with type A edge are laid into exposed T-15 or T-24 grids of galvanized steel sections with lacquered capping.

The grid is suspended with for example adjustable wires. The tiles are pre-painted and demountable.

Loading

The maximum load of the grid – apart from the weight of the tile – for a maximum of 3 mm sagging between the points of suspension, cc 1200 mm, is as follows:

- distributed load: 5 kg/m for T-15
7 kg/m for T-24
- point load: 3 kg for T-15 og T-24
(one point load in the centre)

Tiles

The tiles can – for a maximum of 2 mm sagging – be point loaded with 3 kg/tile.

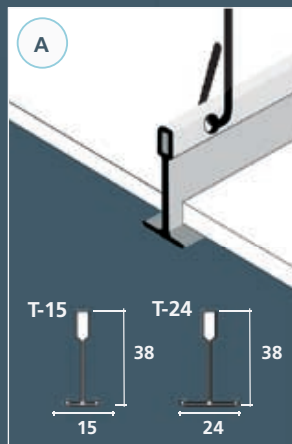

- 1 Main T-section**
 L: T-15 3000 mm
 T-24 3600 mm
- 2 Cross T-section profile**
 L: 600 mm (2A) or
 1200 mm (2B)
- 3 Wall angle**
- 4 Shadow-line moulding**
- 5 Adjustable hanger for 90 - 1500 mm lengths**

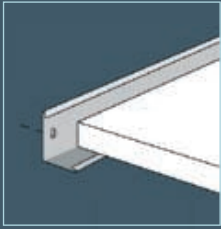

Wall angle

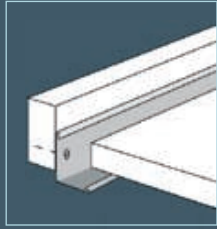

Wall angle with timber strip

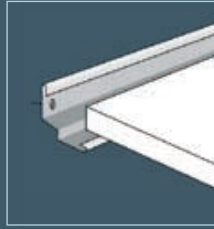

Shadow-line moulding strip

Fastening to wall

Wall angle is fixed using screws suitable for the type of material behind at cc 300 mm. It is an advantage to use a timber strip to fasten the edging.

Colours

Tiles with edge type A are supplied pre-painted white NCS-0500 as standard. Exposed parts of the grid are white lacquered.

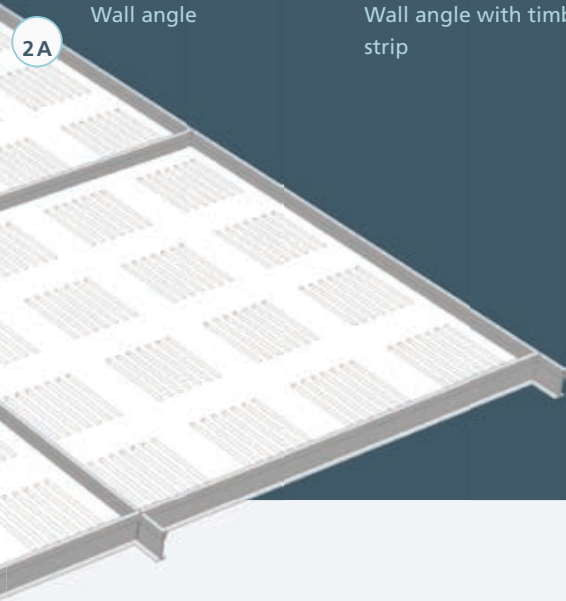

Product and grid system

All Gyptone products with edge type A fit T-15 and T-24 grids.

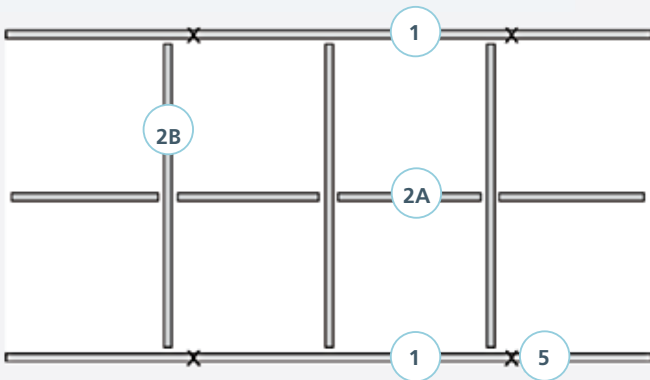

Tiles 600 x 600 mm (modular size)

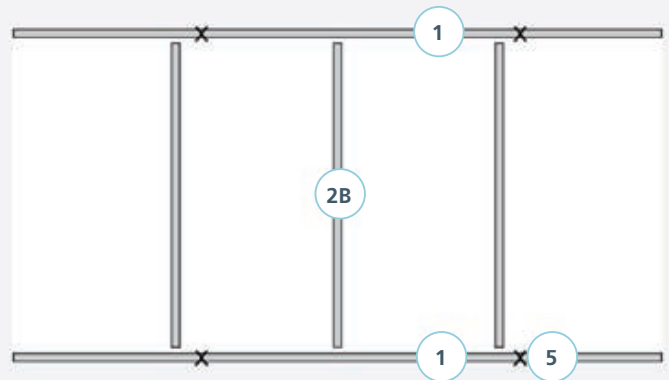

Tiles 600 x 1200 mm (modular size)

Guide to material usage

Guide to material usage per m² for T-15 and T-24 – hangers and accessories

| Item | Term T-15 / T-24 | cc | 600 x 600 mm | 600 x 1200 mm | |
|------|---------------------------|-----------------|--------------|---------------|------------|
| 1 | Main T-section | 4120180/4110180 | 1200 | 0.9 m | 0.9 m |
| 2A | Cross T-section / 600 mm | 4120161/4110161 | 1200 | 0.9 m | - |
| 2B | Cross T-section / 1200 mm | 4120163/4110163 | 600 | 1.7 m | 1.7 m |
| 3 | Wall angle | 4133101/4133301 | - | According to | - |
| 4 | Shadow-line moulding | 4140017/4140018 | - | According to | - |
| 5 | Hangers cc1200 | - | 1200 | 0.7 pieces | 0.7 pieces |

More information can be found on www.gyptone.com

www.gyptone.com

Gyptone.com is not just a home page. Here you can find all Gyptone products "live" – see www.gyptone.com – choose the 3D product gallery and you will enter a 3D universe where all our products can be turned around and over, put together with different systems and displayed exactly the way you want them in your project.



Gyproc A/S
Hareskovvej 12
DK-4400 Kalundborg
Denmark
Tel.: +45 59 57 03 30
Fax: +45 59 57 03 01
e-mail: info@gyproc.com
www.gyptone.com

October 2007

